



F E R R E T T I 6 8 1

# DOMINIQUE

C H A R T E R



## FAST, STYLISH, AND EAGER TO PLEASE!

The 21m M/Y DOMINIQUE from the popular Ferretti 681 series is fast, stylish, and ideally suited to a Croatia yacht charter. Sporting impressive stability and a top speed of 34 knots, guests can explore the stunning Adriatic coast in luxury.

M/Y DOMINIQUE accommodates up to 8 guests in 4 cabins, consisting of a bright and airy full-beam master, a VIP, and two twin cabins, one with L-shaped bunk beds. The yacht is built for entertaining, with three dining spaces across the yacht: one in the beautiful split-level salon, one on the aft deck, and a third up on the flybridge, where there is also a wet bar and sunpads. There's an additional sunbathing space on the bow, while the yacht's swim platform makes boarding the 3.8m tender or the Seadoo Spark jetski easy.

M/Y DOMINIQUE runs with two permanent crew of captain and stewardess; a chef can also be brought on board for an additional fee to enhance the gourmet experience on your Adriatic yacht charter.



SALON

FERRETTI 681 | DOMINIQUE



# MASTER CABIN

FERRETTI 681 | DOMINIQUE



VIP CABIN

FERRETTI 681 | DOMINIQUE



# GUEST CABIN

FERRETTI 681 | DOMINIQUE

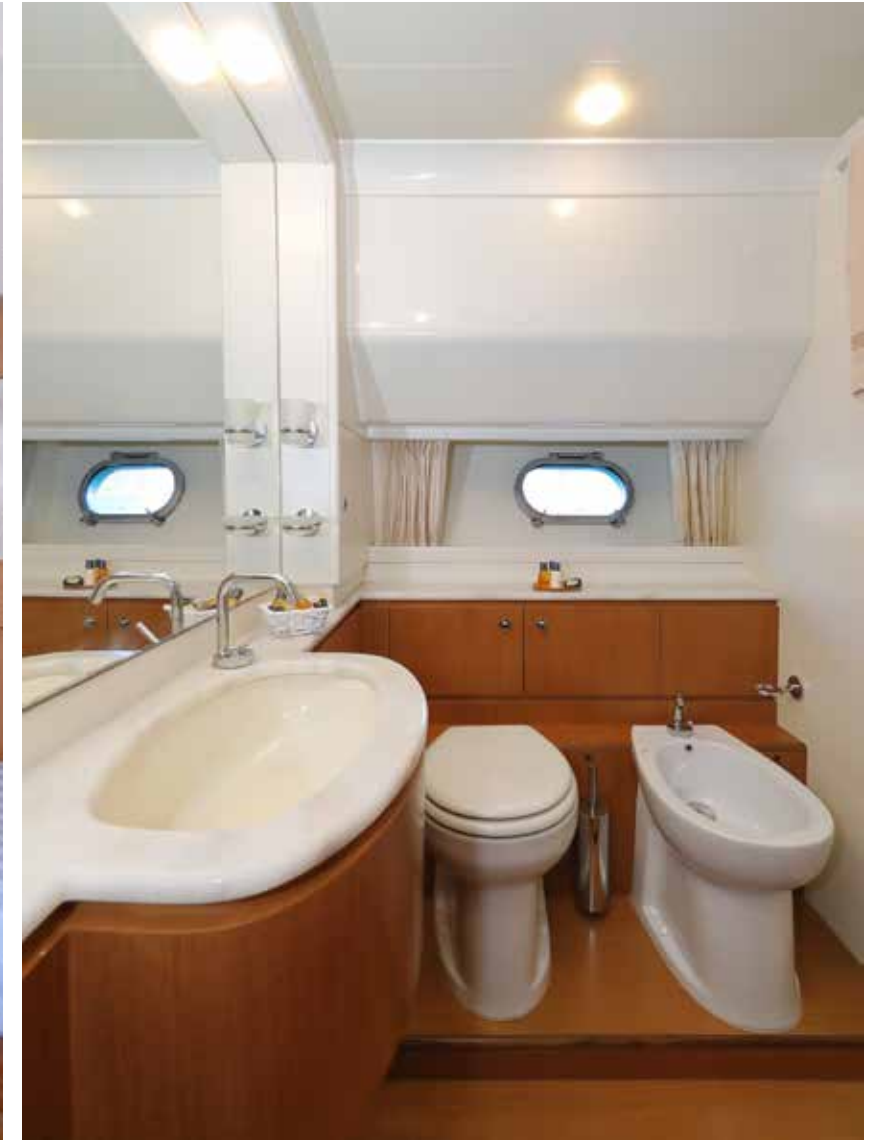

GUEST CABIN

FERRETTI 681 | DOMINIQUE





# EXTERIOR

FERRETTI 681 | DOMINIQUE



# EXTERIOR

FERRETTI 681 | DOMINIQUE







# SPECIFICATION

FERRETTI 681 | DOMINIQUE



## GENERAL

BUILDER	Ferretti / Ferretti 681
YEAR	2006, in water from 2007
LENGTH	21.2 m (69'7")
BEAM	5.63 m (18'6")
DRAFT	1.72 m (5'8")
HULL CONSTRUCTION	GRP
FLAG	Croatia
HOME PORT	Rijeka

## ACCOMMODATION

Total Guests (sleeping)	8
Total Guests (cruising)	10
Number of Cabins	4
Cabin configuration	2 Double, 2 Twin
Bed configuration	1 Double, 1 Queen, 4 Single
Total Crew	2 (Captain and Stewardess)

## CABIN ARRANGEMENT

- Beam-wide Master stateroom mid-ships, ensuite bathroom
- VIP cabin forward, ensuite bathroom
- Port guest cabin with twin beds, ensuite bathroom
- Starboard cabin with L-shaped bunk beds, shared bathroom

## TECHNICAL INFORMATION

Engines	2 x 1360 hp MAN 12V CRM
Generator	20 kW and 11 kW generator
Fuel Consumption	306 l/h @ 24 kn, 260 l/h @ 20 kn
Cruising Speed	28 kn
Maximum Speed	34 kn
Fuel capacity	4.000 L
Water capacity	920 L + watermaker



## TENDERS & TOYS

---

- 3.80m tender with 60 Hp YAMAHA
- 1 x Sea-Doo SPARK (2018)
- 1 x SUP
  - 1 x Towable donut
- 1 pr Water ski
- 2 pr Snorkelling gears (adults)

## AUDIO VISUAL EQUIPMENT

---

- BOSE Surround Hi-Fi system with loudspeakers in Saloon and Cockpit
- Fusion System on the Flybridge
- 40" flat screen SAT TV in the Saloon with DVD
- 25" flat screen TV's and in each guest cabin

## OTHER

---

- WiFi throughout
- Air Conditioning
- Watermaker 160 l/h
- Washing and drying machine

## KEY FEATURES

---

- Underwent soft refit ahead summer 2020
- All new water toys (2020)
- Bright and pleasant interior
- Family and children friendly yacht

# LAYOUT

FERRETTI 681 | DOMINIQUE

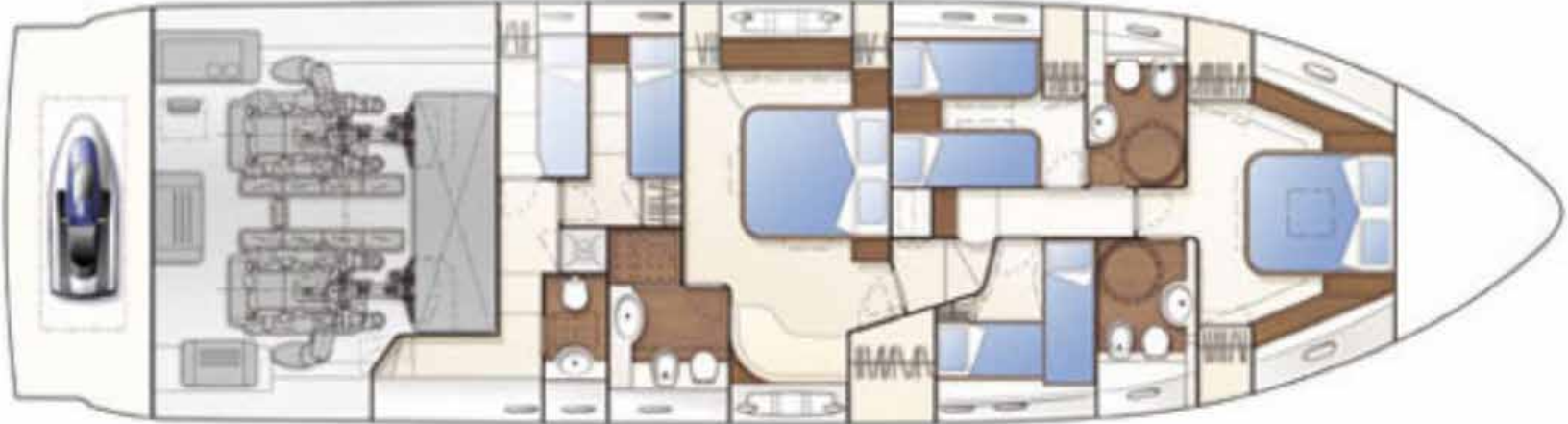



DISCLAIMER: This document is not contractual. All information is subject to change without notice and is without warranty. All particulars are given in good faith and are believed to be correct but cannot be guaranteed.